

Outer shell	: Stainless steel (AISI304)	-
Collet nut + clamps + screw	: Stainless steel (AISI304)	-
Insulator	: PEEK	-
Female contact	: Bronze (UNS C54400)	Gold plated (ISO 4523)
Clip	: Stainless steel (AISI416)	-
Gland	: EPDM	-
Other outer metallic parts	: Stainless steel (AISI304)	-
Other inner metallic parts	: Brass (UNS C38500)	Nickel plated (FS-QQ-N-290A)
O-rings	: EPDM	-
Marking strip	: Epoxy paint	black

Panel cut-out

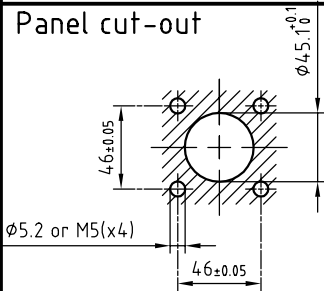

Stripping

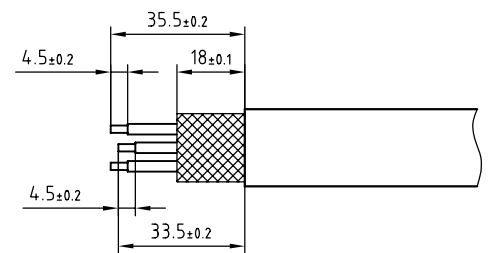

Fixed socket with square flange , 4 screws fixing , with long pre-positioning sleeve and cable clamps  
Series 5N , multipole (10)

ETUDE N°

Echelle	Dessiné	12.08.03	OVU / RMO
	Contrôle	13.08.03	RMO / CDE
	Modif.	01	13.08.03 / OVU



**LEMO**

CH-1024 Ecublens

**PBG.5N.310.TLLY** \_\_ \_\_